

TORAUTOMATIC
Put Loparica 23
10020 ZAGREB



ENGLISH - LED traffic light with two lights - power 230 V a.c.

CE

(EN) TECHNICAL DATA SHEET

Power supply: **230 V a.c.**

Weight: **2,65 Kg.**

Lens color: **Red, green, Yellow.**

Lamp consume: **3 W.**

Middle life lamp: **100.000 hours.**

Degree of protection: **IP 65**

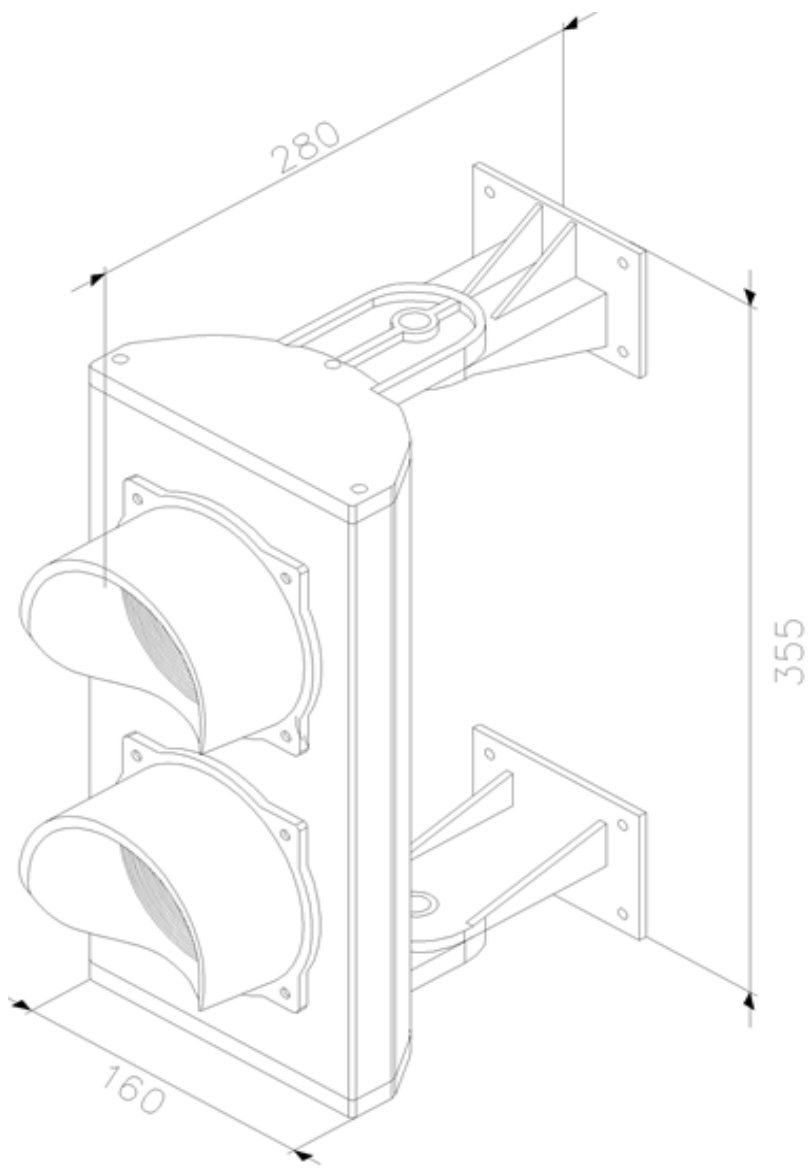

SCHEDULE OF ASSEMBLY

Rif.	CODE OEPLA
1	MS010119
2	PS010061
3	PS010062
4	PS010063
5	MS010136
7	MS010120
8.1	PS010065 (RED)
8.2	PS010066 (GREEN)
8.3	PS010067 (ORANGE)
9	MS010121
10	PS010064
11	MS010122
12	MS010123

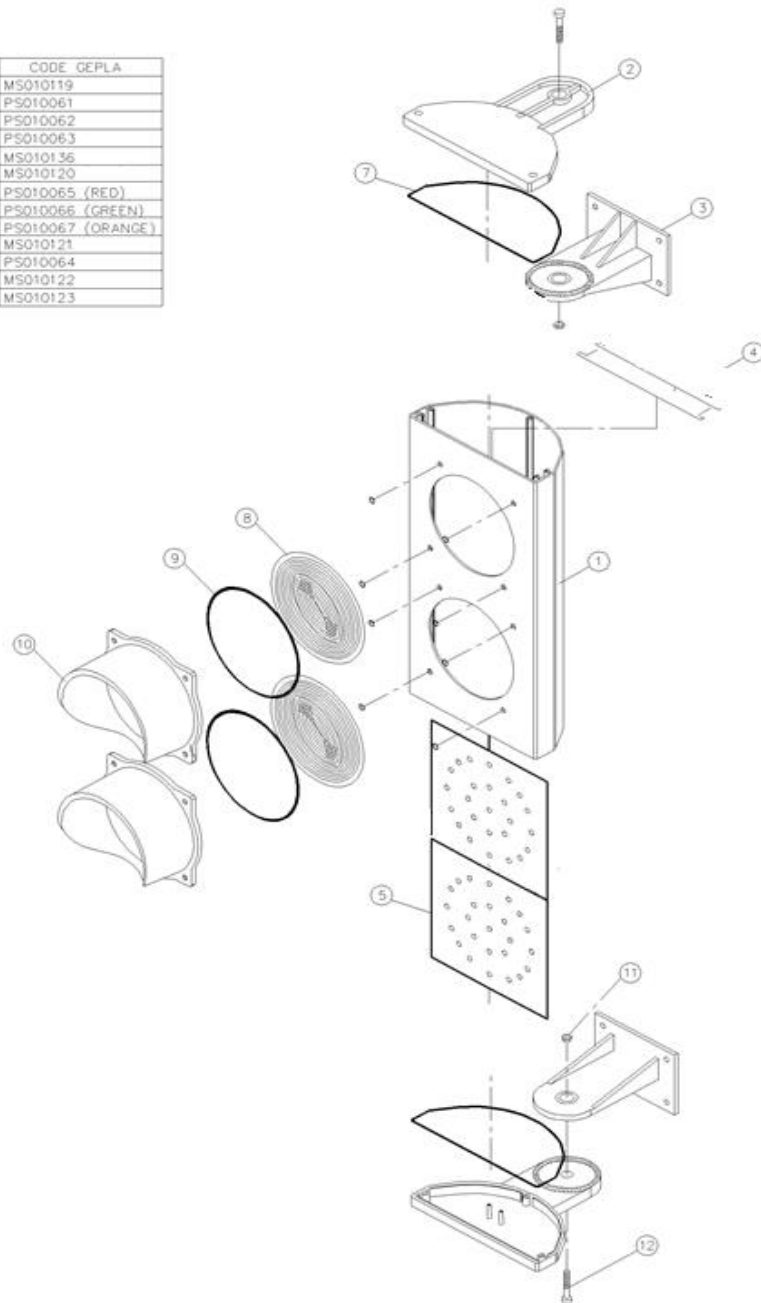

ELECTRICAL DIAGRAM

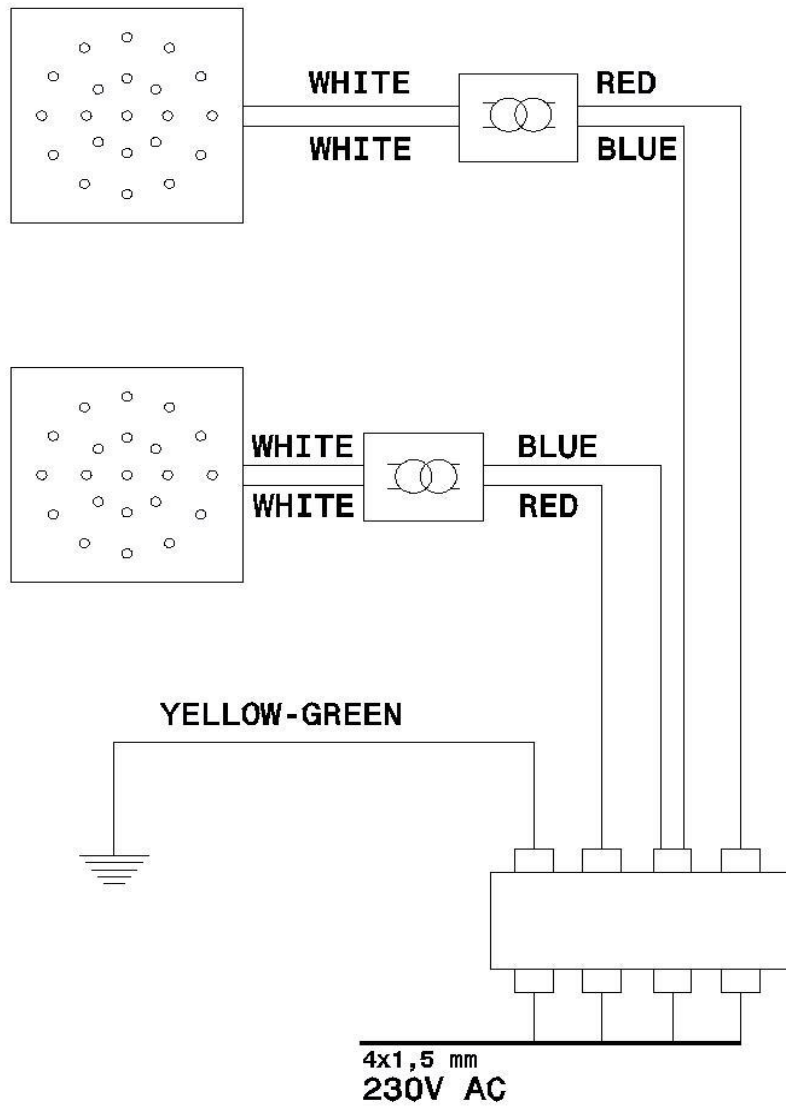

(EN) ASSEMBLY POSITIONS

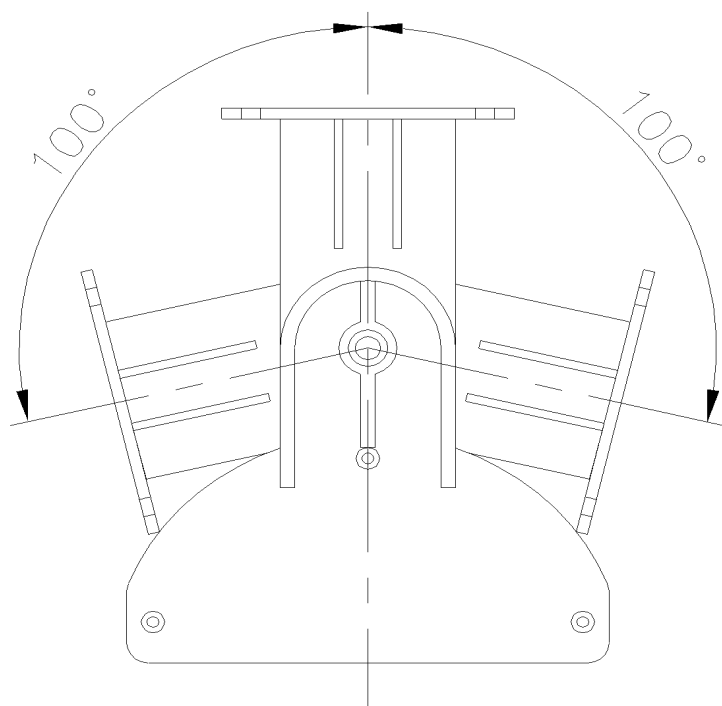



(EN) ATTENTION!

- Before connecting the electrical cables make sure that the power supply is off.
- The traffic lights have to be installed by qualified technical staff only.
- Used vacuum cleaners still contain many recyclable materials. Therefore please take used vacuum cleaners to your retailer or recycling center so that they can be recycled.

TORAUTOMATIC
Put Loparica 23
10020 ZAGREB